



Quick Start Guide

ConnectPort® X4 IA Cellular



90001236-88 D

Welcome to your Digi product

Get started: This guide helps you with initial product setup. Need more? Find additional product support at www.digi.com/support/ConnectPortX4. Or connect to the online documentation by scanning this code:



Digi Technical Support: Digi offers multiple support plans to help you get the most out of your product. For information on Technical Support plans and pricing, contact us at 877.912.3444 or visit www.digi.com/support.

Documentation Feedback: To provide feedback on this documentation, send your comments to techcomm@digi.com.

1 Verify your components

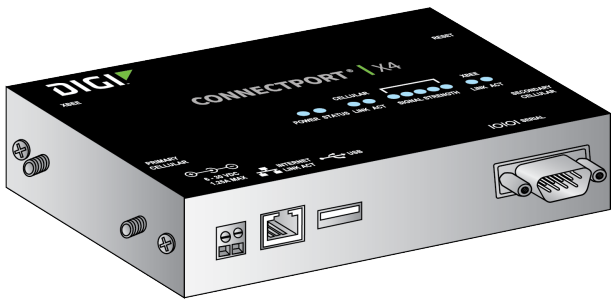

ConnectPort X4

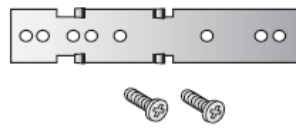

DIN rail mounting bracket



Ethernet cable



XBee antenna

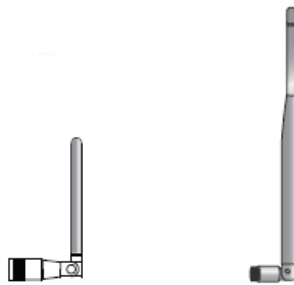

Direct mount antennas

Part number	# of Direct mount antennas
X4-xxx-P01-x	1
All other models	2

Verify that you have all included equipment. If any item is missing or damaged, contact your supplier.

2 Insert SIM card(s)

Note If your device uses a SIM card, you must insert the SIM card. If your device does not use a SIM card, you can skip this step.

1. Remove the SIM slot cover plate.
2. Insert SIM card(s) as shown. Insert the end of the SIM card with the chamfered corner first.
 - Install the primary SIM card in the upper SIM slot with the contacts face down.
 - Install the secondary SIM card in the lower SIM slot with the contacts face up.
3. Reattach the SIM slot cover plate when finished.

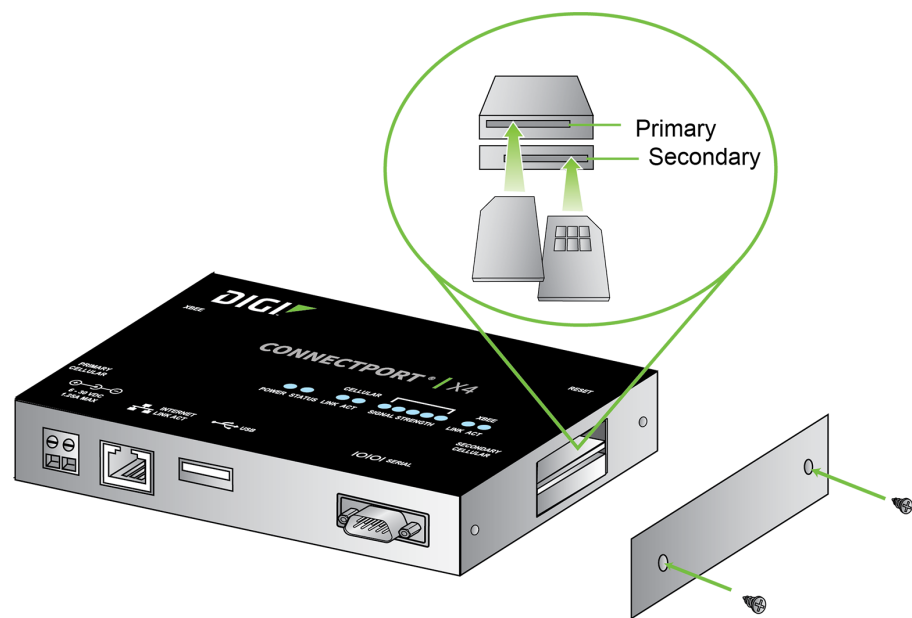

3 Connect the hardware

- Using the two provided screws, attach the DIN rail mounting bracket to the ConnectPort X4.



- Connect accessories as shown.
 - Connect the XBee antenna.
 - Connect the primary direct mount antenna. If you are using two direct mount antennas, connect the secondary antenna on the opposite side of the device.
 - Connect the Ethernet cable to the device. You can connect the other end to an Ethernet network.

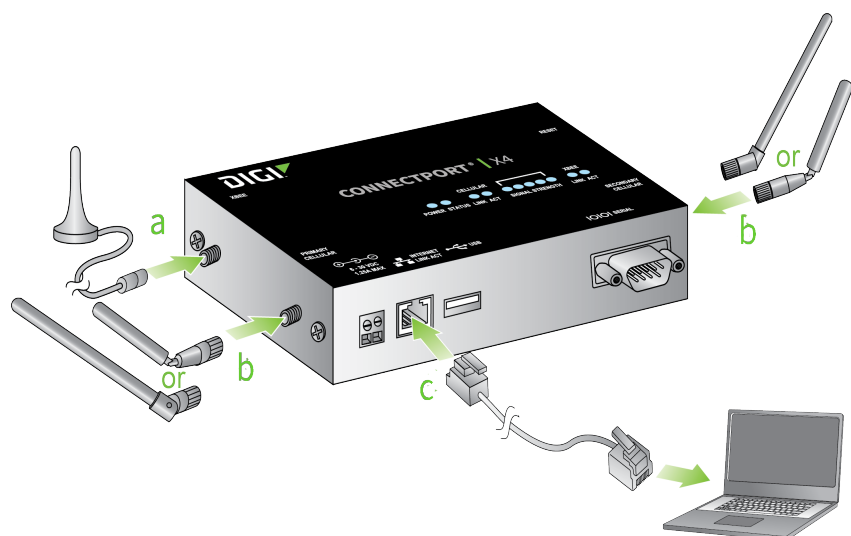

- Open the power connectors (+ and -).
 - Insert a small screwdriver into the bottom compartment of the connector at a 30-degree angle.
 - Push the screwdriver down to open the connector.
- Insert the bare wire from a 6-30 VDC power source into the power connectors. Follow the labeling of the positive (+) and negative (-) power connectors on the device. The positive connector is the leftmost one.
- Power up the ConnectPort X4.

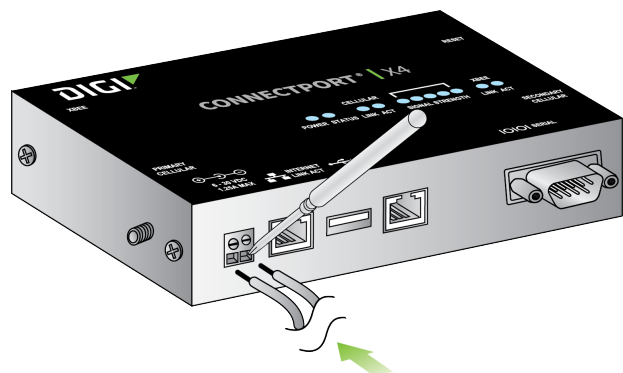

4 Next steps

After you have connected the hardware, you should configure the ConnectPort X4. Refer to the [ConnectPort X4 Getting Started Guide](http://www.digi.com/support/connectportx4) which can be found at www.digi.com/support/connectportx4.